

TP232 (RS232 Terminal Plus)

GSM / GPRS stand alone terminal with serial interface.



Duetech Beres Ltd



GPRS Class10



Internet Connectivity



Logic Flow Configuration SW



Quad Band GSM SMS/GPRS



RS232 Serial port



Event report



9-24V DC Supply

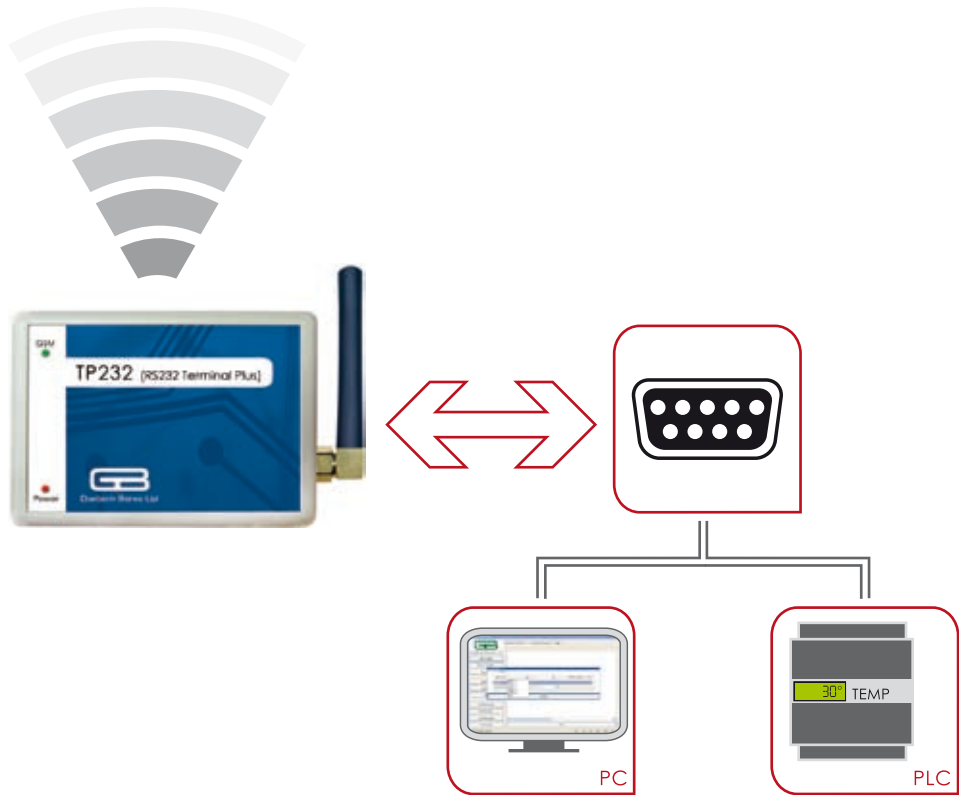

- GSM/GPRS Quad Band
- GPRS class B, Multislot 10
- Transmit Power: Class4 (2W @ 850/900 MHz)
- Class 1 (1W @ 1800/1900 MHz)
- Reset button
- RS232 Interface
- SMA antenna connector
- Host Protocols: AT Commands, UDP/API
- Internal Protocols: PPP,UDP/API/PAD, CMUX, TCP/PAD
- 1 Indication LEDs
- Operating Temperature: -30C to 85C
- Operating Power: 9-24VDC
- Certifications: CE
- Dimensions: 67x93x28mm

The **TP232** is a compact GSM/GPRS stand alone Terminal.

The **TP232** can connect to virtually any device with a serial port.

This integrated platform can be utilized to enable devices send SMS messages and transfer data over GSM/GPRS.

The **TP232** supports onboard TCP/IP network protocols (TCP/UDP) and also can be used by Windows as a Dial Up standard modem.

An internal dedicated microprocessor will make sure cellular connectivity is always enabled, if any network problem occurs, the **TP232** will recover automatically.

Data transfer watchdog – this device can be configured to reconnect if data has not been transferred within a user defined period of time.



Supports **TP232 Management application** to set up user defined parameters such as Data Watchdog time value and scheduled/ periodical reset time value.

ADD PLUG – AND – GO WIRELESS TO REMOTE MONITORING & RURAL INTERNET APPLICATIONS

enfora inside